



Adjustable Sway Brace Attachment to Steel

800

Technical Features

- **Sizes available** : Fits 102mm / 4" to 457mm / 18" wide steel beams.
- **Functions** : Seismic brace attachment to steel.
- **Features** : Permits secure and concentric connection to steel when drilling or welding is not allowed or desired. Allows bracing in both lateral (across beam) and longitudinal (along beam) direction. Includes Series 65 or 66 Beam Clamps. **Malleable iron components such as clamps must never be substituted.**
- **NOTE** : Must be used with Series 900 Brace Fittings and Series 65 or 66 Beam Clamps.
- **Material** : Carbon steel
- **Finish** : Plain or Electrogalvanized

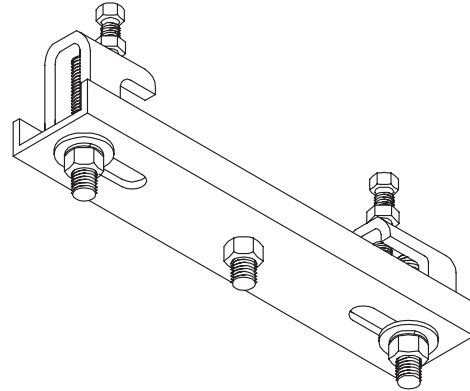

1 - When used with other Tolco® bracing products.



Adjustable Sway Brace Attachment to Steel - 800

Physical Data

Maximum Beam Flange Thickness (mm / inch)	Beam Width Range (mm / inch)	Lateral (Across Beam) Design Load (kg / lbs)	Longitudinal (Along Beam) Design Load (kg / lbs)	Reference	
				Plain	Electrogalvanized
19.1 / 0.75	101.6-152.4 / 4.00-6.00	914 / 2015	574 / 1265	800-1-1	800EG-1-1
19.1 / 0.75	152.4-203.2 / 6.00-8.00	914 / 2015	574 / 1265	800-1-2	800EG-1-2
19.1 / 0.75	203.2-254.0 / 8.00-10.00	914 / 2015	574 / 1265	800-1-3	800EG-1-3
19.1 / 0.75	254.0-304.8 / 10.00-12.00	914 / 2015	574 / 1265	800-1-4	800EG-1-4
19.1 / 0.75	304.8-355.6 / 12.00-14.00	914 / 2015	574 / 1265	800-1-5	800EG-1-5
19.1 / 0.75	355.6-406.4 / 14.00-16.00	914 / 2015	574 / 1265	800-1-6	800EG-1-6
19.1 / 0.75	406.4-457.2 / 16.00-18.00	914 / 2015	574 / 1265	800-1-7	800EG-1-7
31.8 / 1.25	101.6-152.4 / 4.00-6.00	914 / 2015	574 / 1265	800-2-1	800EG-2-1
31.8 / 1.25	152.4-203.2 / 6.00-8.00	914 / 2015	574 / 1265	800-2-2	800EG-2-2
31.8 / 1.25	203.2-254.0 / 8.00-10.00	914 / 2015	574 / 1265	800-2-3	800EG-2-3
31.8 / 1.25	254.0-304.8 / 10.00-12.00	914 / 2015	574 / 1265	800-2-4	800EG-2-4
31.8 / 1.25	304.8-355.6 / 12.00-14.00	914 / 2015	574 / 1265	800-2-5	800EG-2-5
31.8 / 1.25	355.6-406.4 / 14.00-16.00	914 / 2015	574 / 1265	800-2-6	800EG-2-6
31.8 / 1.25	406.4-457.2 / 16.00-18.00	914 / 2015	574 / 1265	800-2-7	800EG-2-7

Installation Instructions

Tighten the set bolt on the beam clamp against the beam flange until the set bolt head breaks off. Tighten down locking jam nut on set bolt against the beam clamp body. Tighten the hex head bolt into the beam clamp until the lock washers are fully flat.

IMPORTANT NOTE : Do not substitute malleable iron beam clamps or other type of brace fitting. Use only Series 65 or 66 beam clamps and Series 900 brace fittings from Tolco® and available from Viking SupplyNet®.